

# Dormont Junction

## Station Improvement Project

30% Design Update  
Transit-Oriented Communities Program

TOC Program  
Planning & Service Development Department

**PortAuthority**

Virtual Public Meeting  
Monday, April 26th, 2021



# Housekeeping

- Interpreter instruction
  - Closed caption instruction
  - Mute yourself
  - Hold questions until the end
  - Submit questions through the chat function
- 
- This meeting is being recorded and will be uploaded to [PortAuthority.org/DormontJunction](https://PortAuthority.org/DormontJunction)

# Welcome!

**PortAuthority**

# What is TOD?

Transit-oriented development is:

- Dense.
- Mixed-use.
- Walkable.
- Close to high-quality transit.



**PortAuthority**

# Port Authority Roles in TOD

- TOD **sponsor** for joint development
- TOD **stakeholder** for any development that occurs within the “zone of influence” of current or future stations
- TOD **advocate** for sustainable land use decisions along all of the Pittsburgh region’s transit corridors

# Transit-Oriented Communities

- TOD Guidelines
- TOD Zoning
- First and Last Mile
- Station Improvement Program
- Joint Development

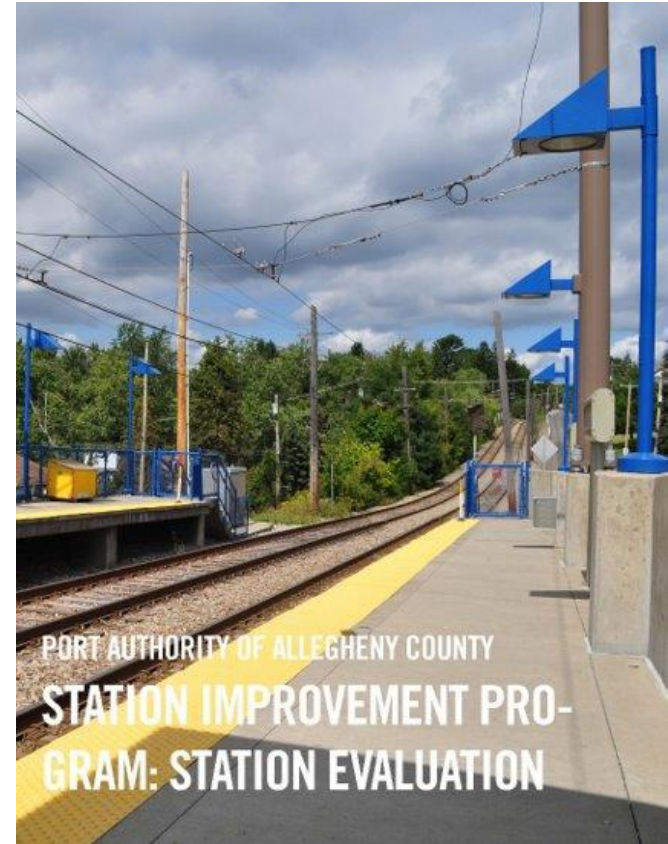

# Station Improvement Program

Capital funds allocated to date: \$2,800,000

- Phases
- Station Evaluation
- **Planning + Design**
- Construction
- Repeat

**PortAuthority**

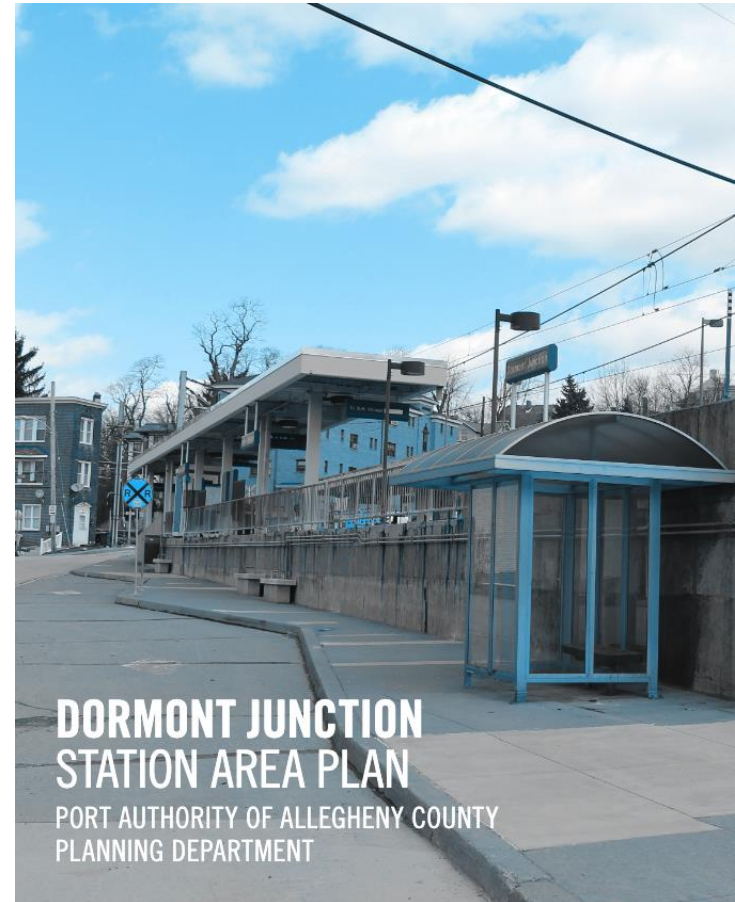



# Dormont Junction Station

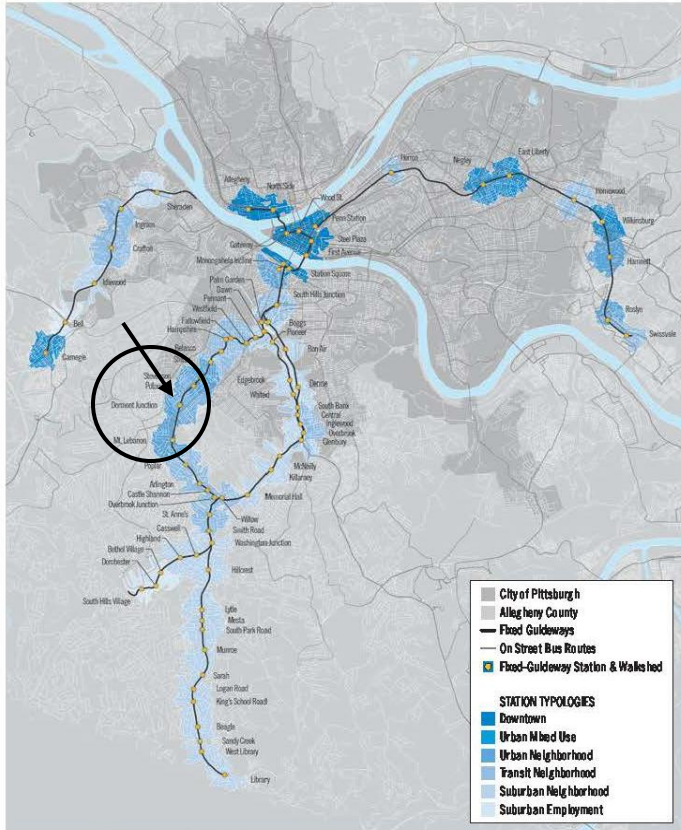

- Red Line light rail (every 12 min)
- 41 bus (every 20 min)
- 23-minute ride to/from Downtown
- 878 trips per day



# User Input



What barriers/obstacles did you encounter as you make your way to this facility?

Answer	Count	%
I experienced no barriers/obstacles	118	68.2%
I felt unsafe from traffic	31	17.9%
Long waits	13	7.5%
No or poor condition sidewalks	12	6.9%
Lack of lighting	4	2.3%
I felt alone	3	1.7%
I felt confused	3	1.7%
No or poor condition crosswalks	3	1.7%

Where are you coming from/where are you going?

Dormont Junction	
Between Work and Home	66.0%
All Other Combinations	34.0%

Travel Distance:

Dormont Junction	
Less than 1 Mile	54.2%
Greater than 1 Mile	45.8%

Barriers / Obstacles:

Dormont Junction	
None	54.0%
Poor Sidewalks	25.3%
Difficult Terrain	14.3%
Unwelcoming	12.7%
Unsafe Passage	4.0%
Dangerous Vehicular Traffic	2.4%
No/Insufficient Lighting	1.6%
Walkway Obstacles	1.6%

What would you like to see that would make this station better?

Dormont Junction	
Design	50.8%
Parking Amount	23.1%
Safety	16.2%
Information	15.4%
Amenities	15.4%
Pathways	14.6%
Accessibility	5.4%
TVM's	4.6%



**PortAuthority**

\* Sample size of 146 of 380, confidence level of 95%, confidence interval of 6.37

# Station Access: Biltmore

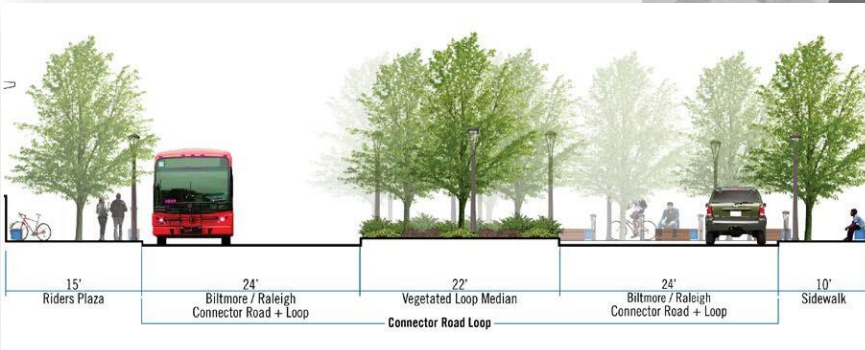



# Station Access: Raleigh + Park

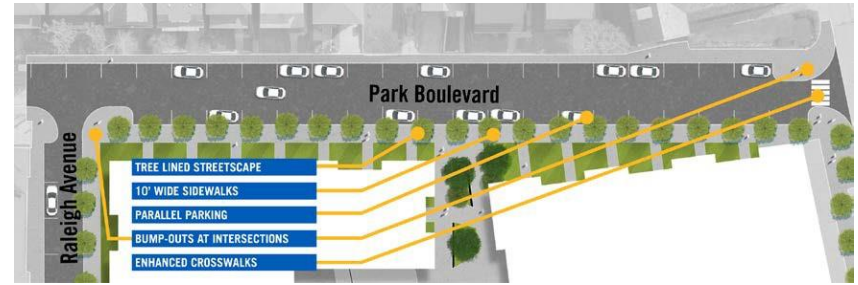
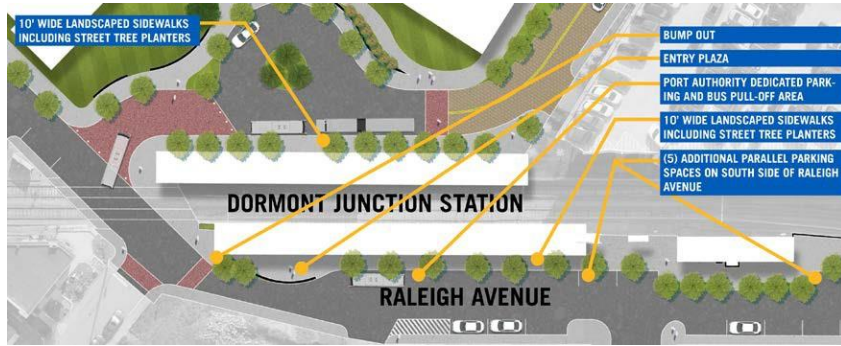

# Station Conceptual Design

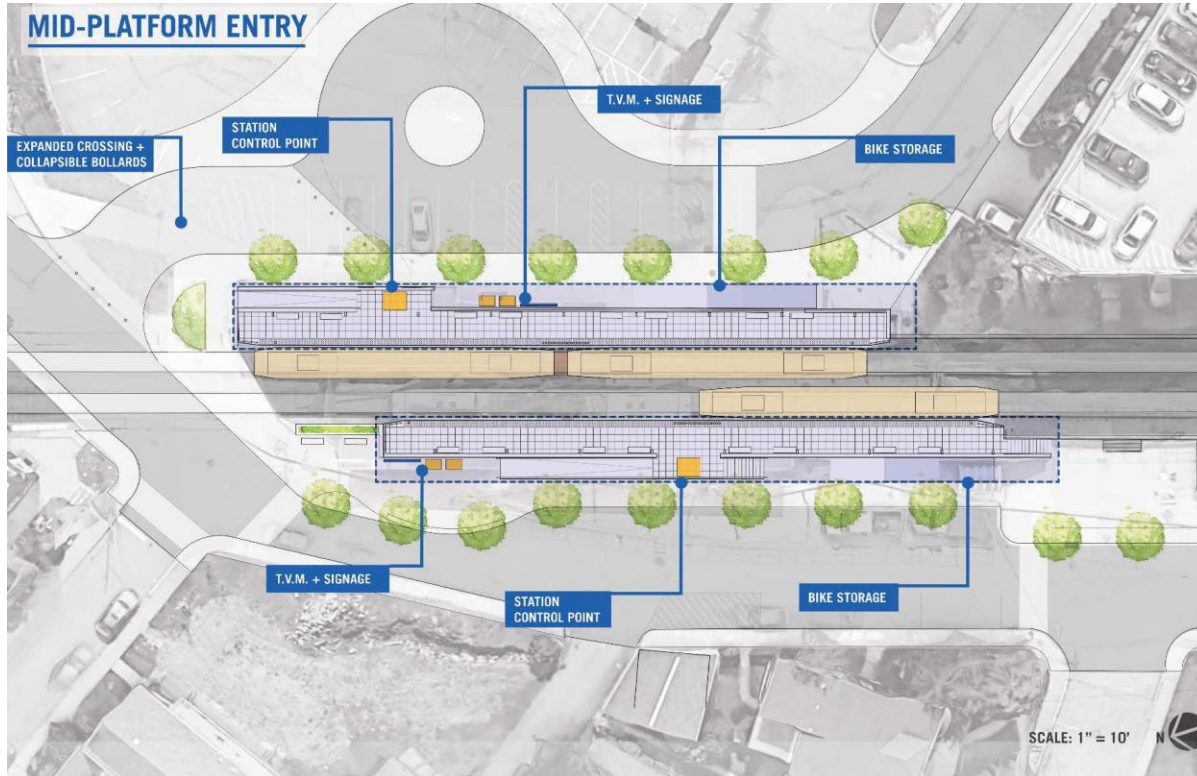



# Station Conceptual Design

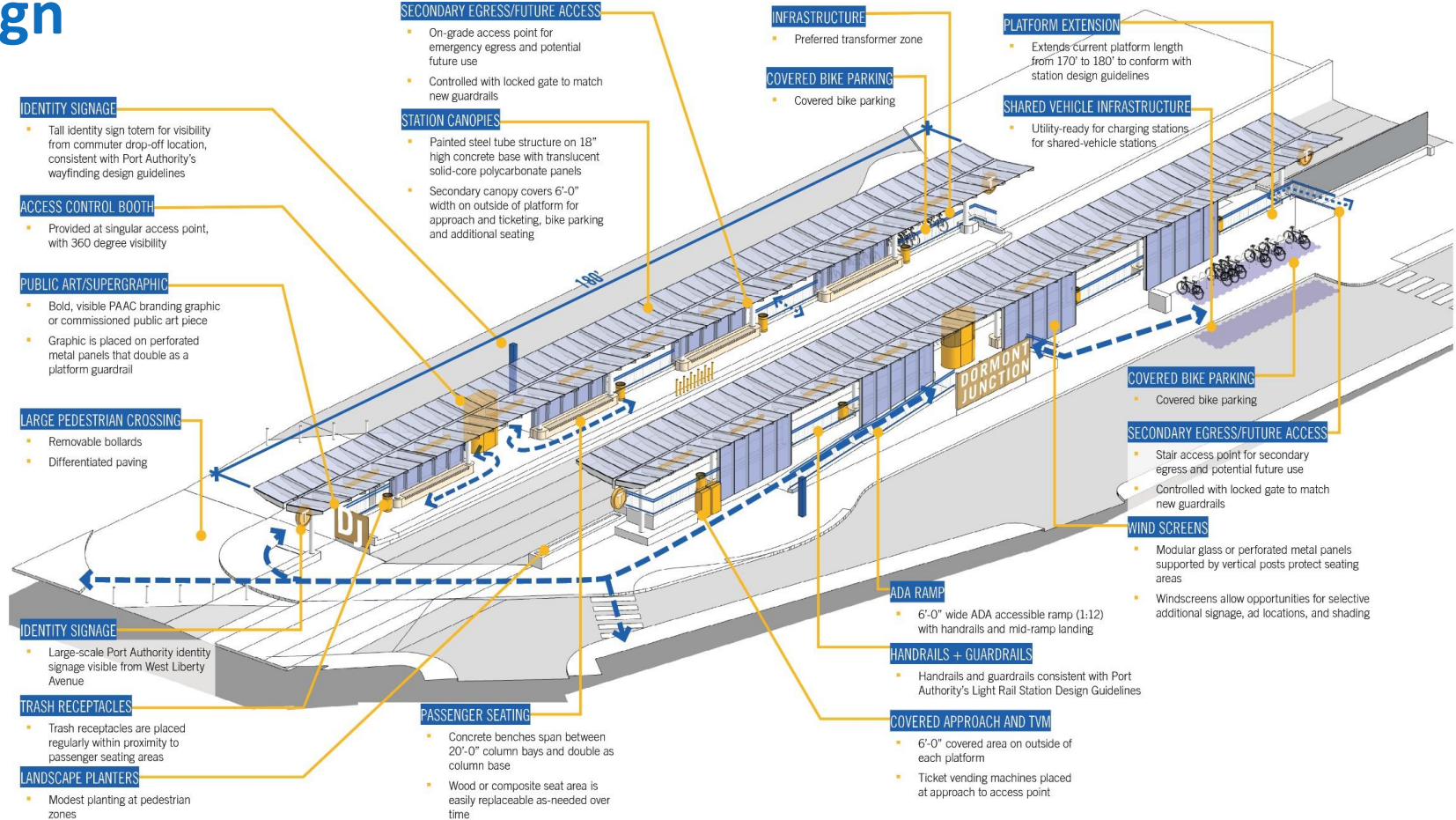

# Conceptual Design: Transit-Oriented Development

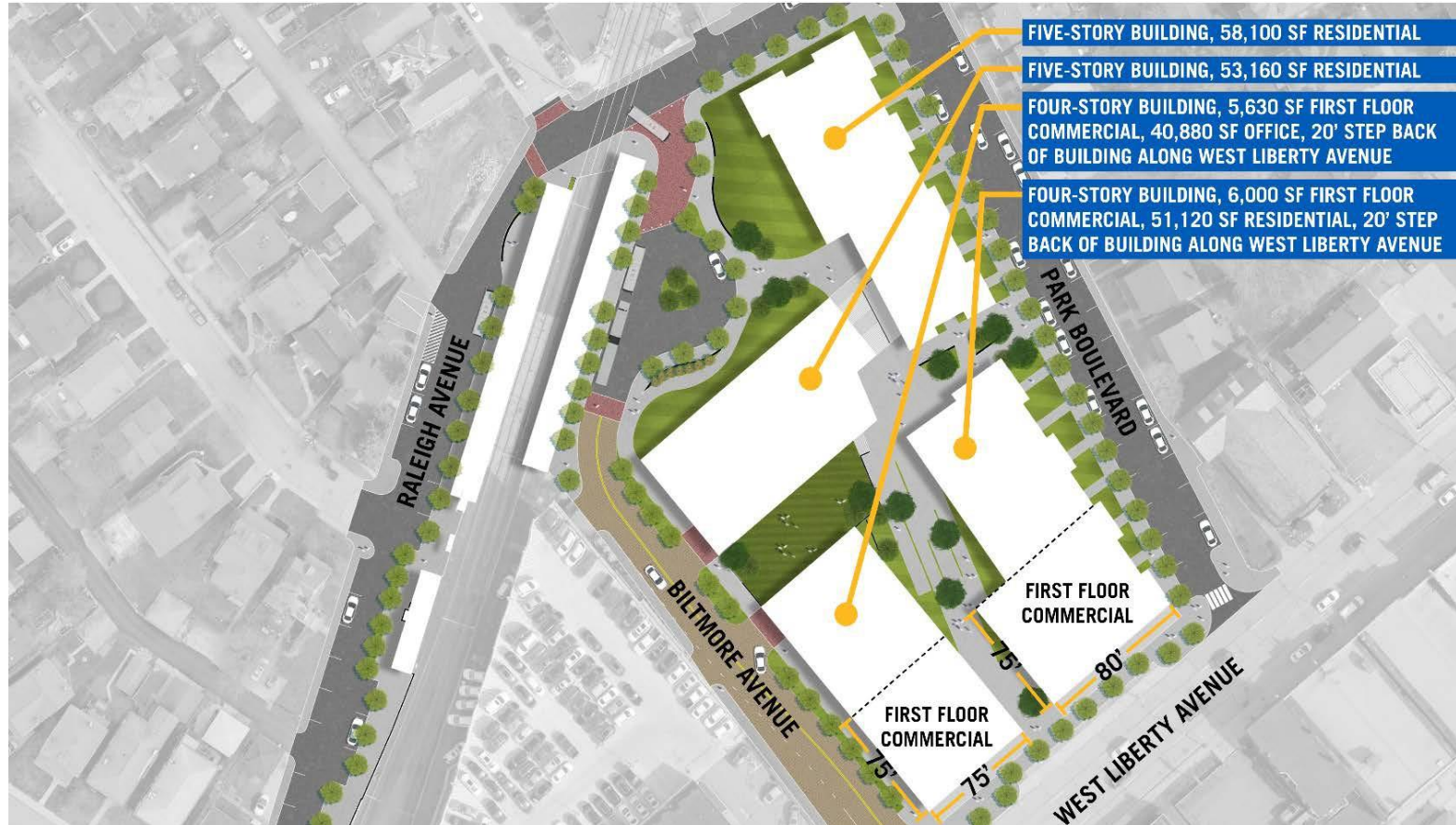



# 30% Design: Landscape Concept

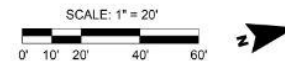

# 30% Design: Proposed Overall Station

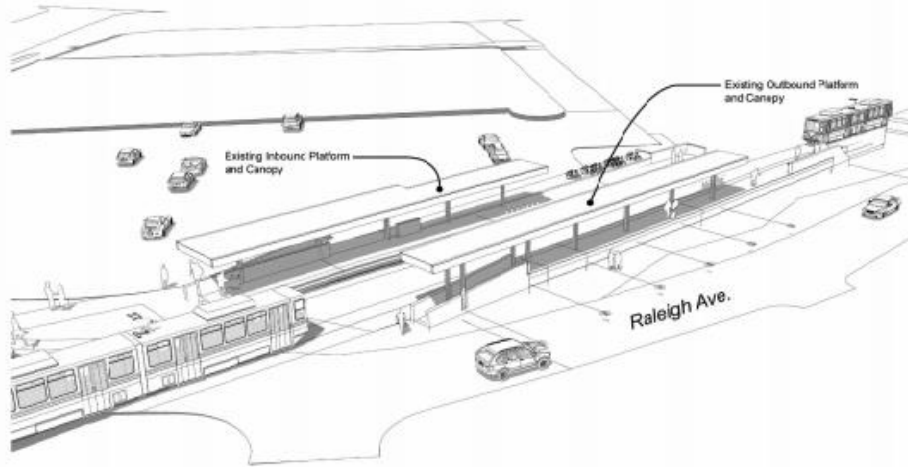

EXISTING  
OVERALL STATION



PROPOSED  
OVERALL STATION

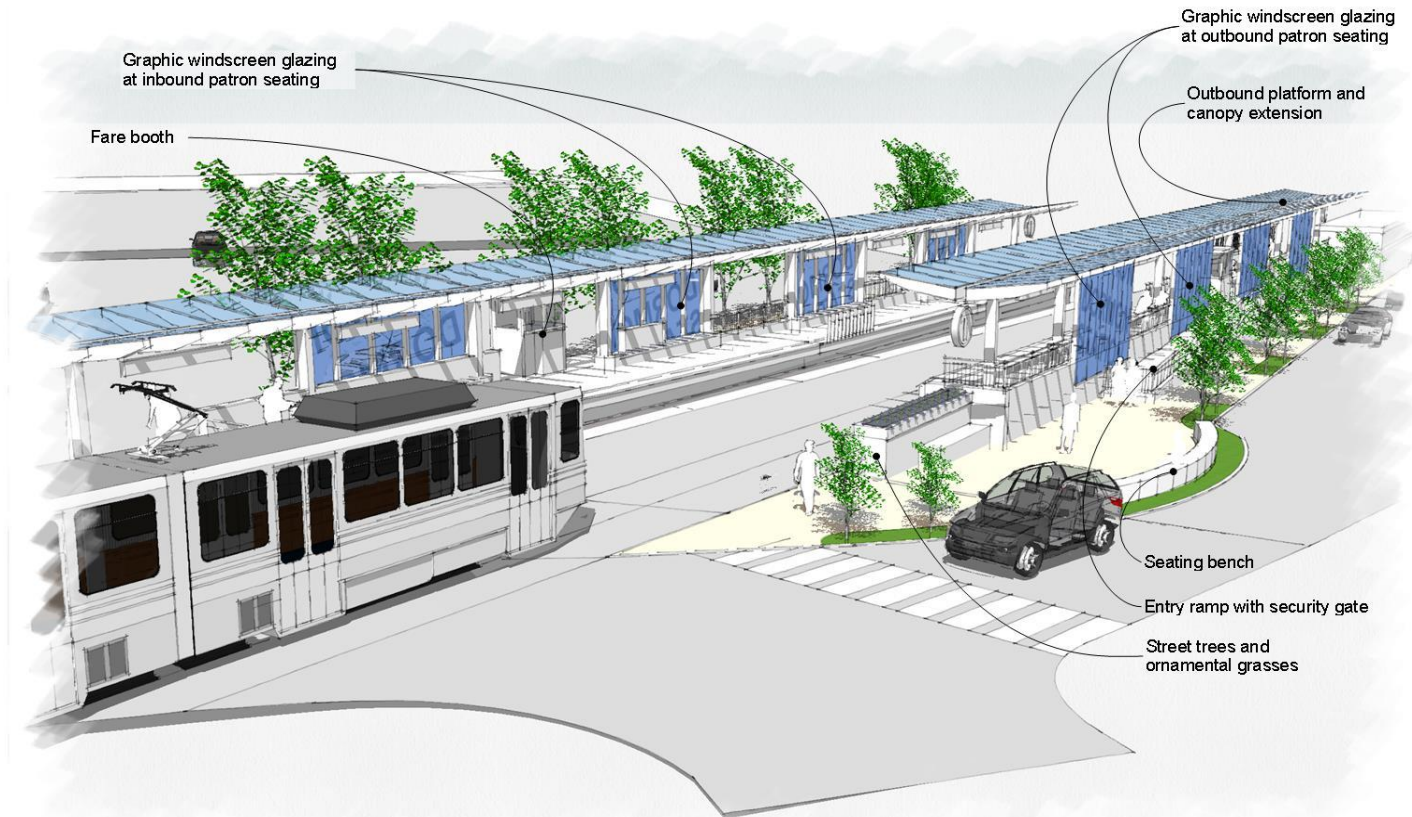



# 30% Design: Proposed Overall Station

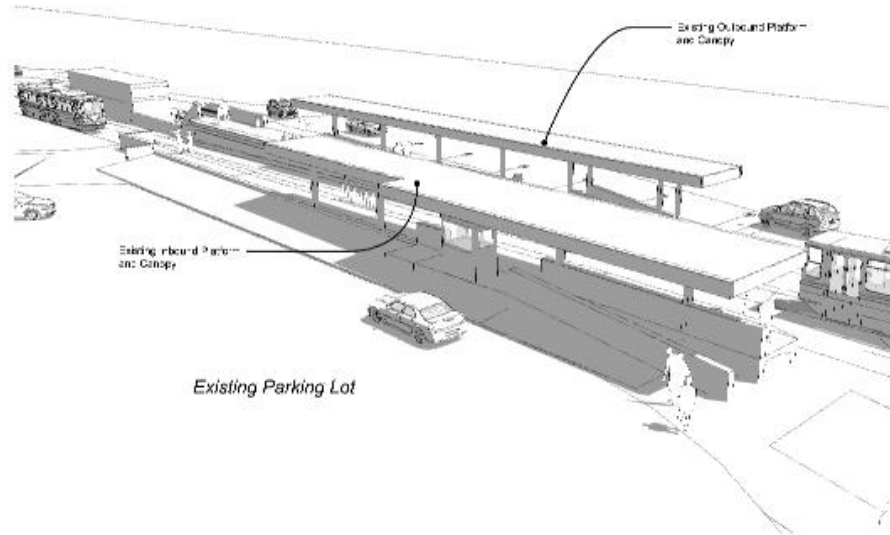

EXISTING  
OVERALL STATION

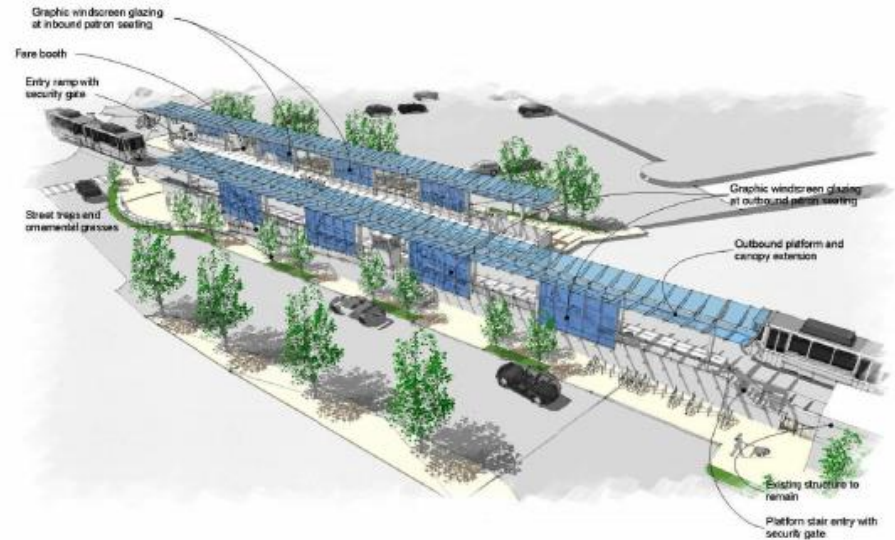

PROPOSED  
OVERALL STATION

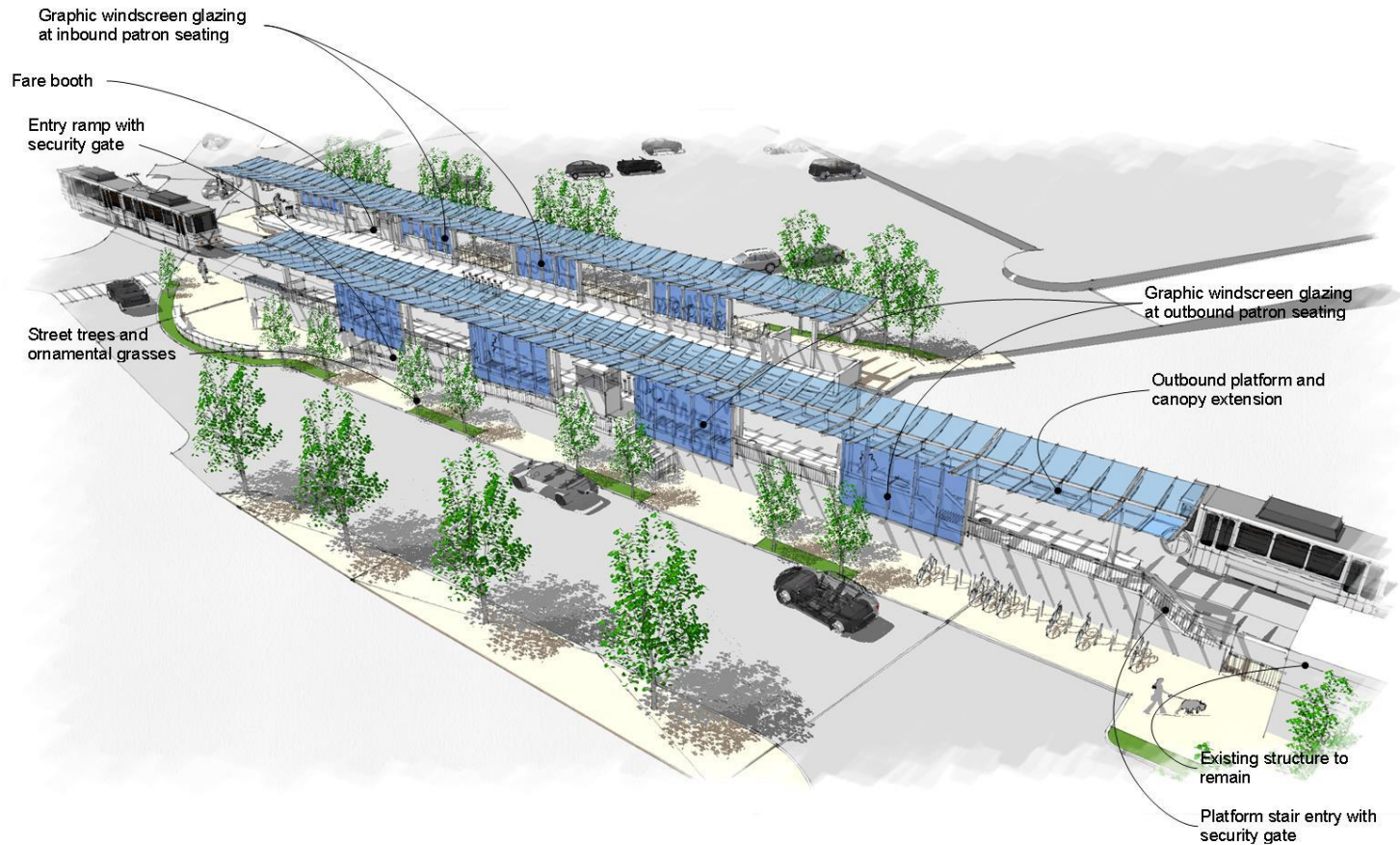

# 30% Design: Proposed Outbound Platform

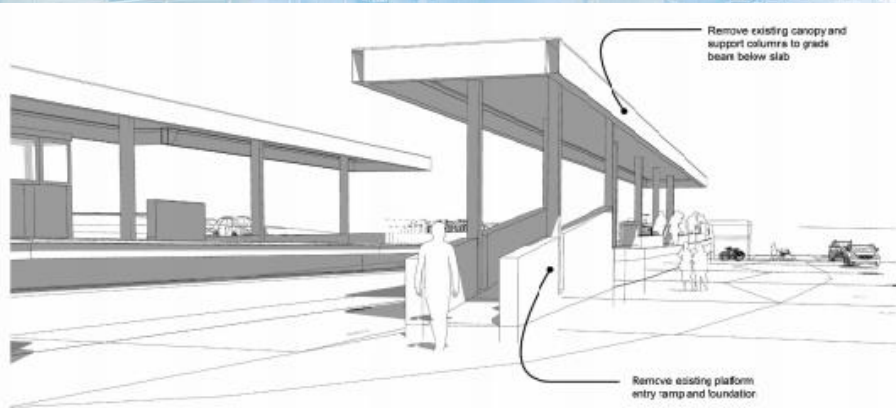

EXISTING  
OUTBOUND PLATFORM

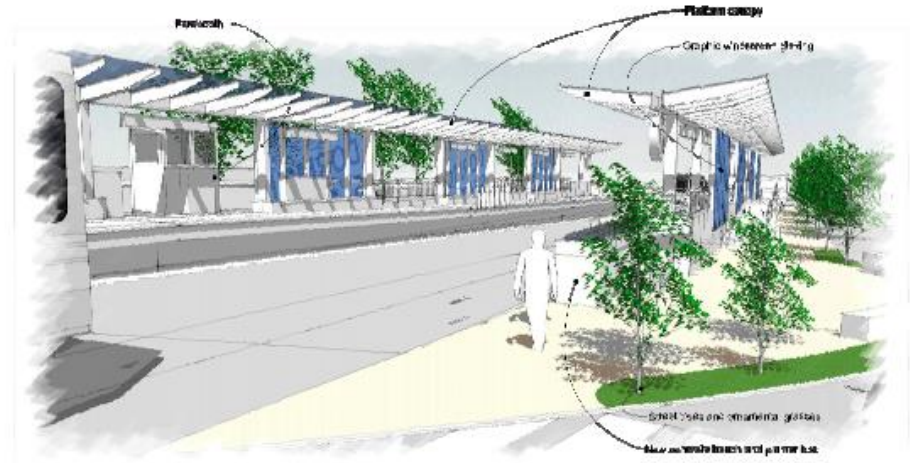

PROPOSED  
OUTBOUND PLATFORM



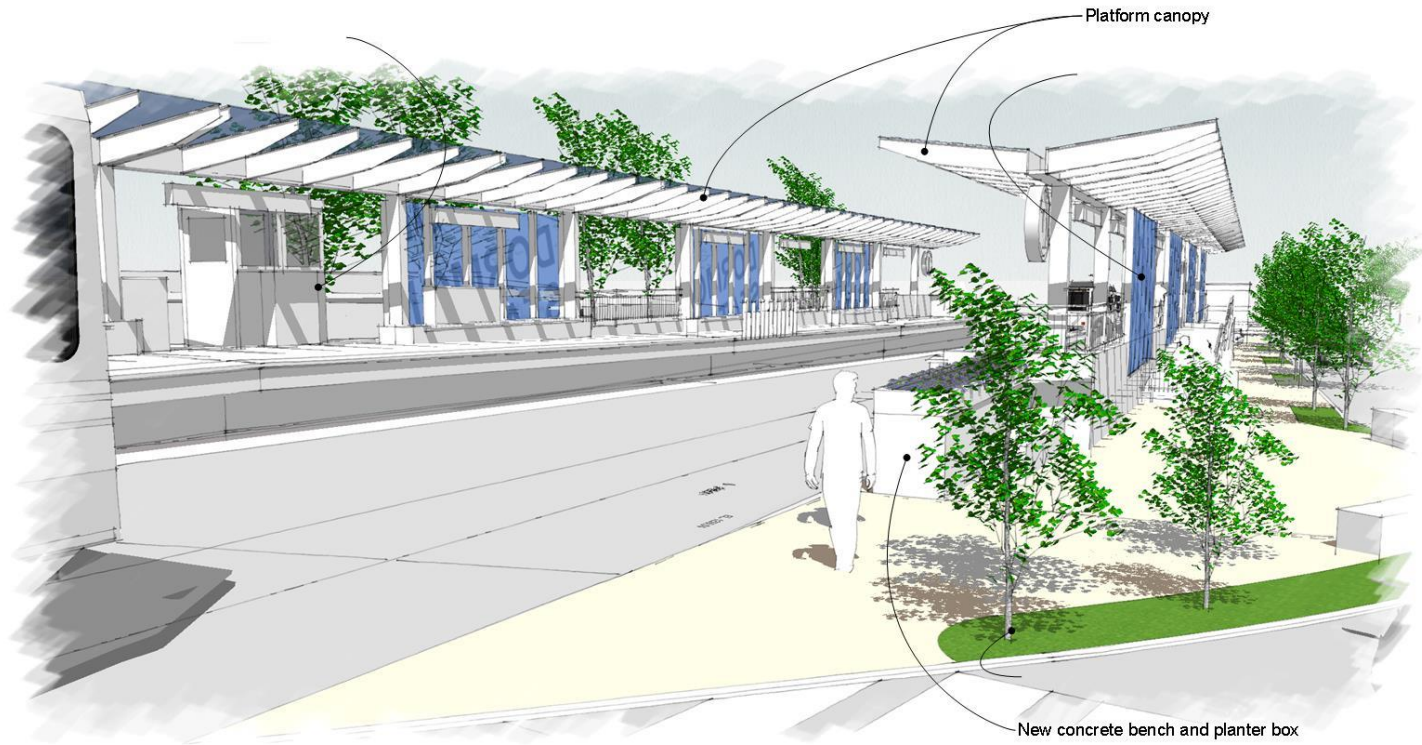

# 30% Design: Outbound Platform Detail

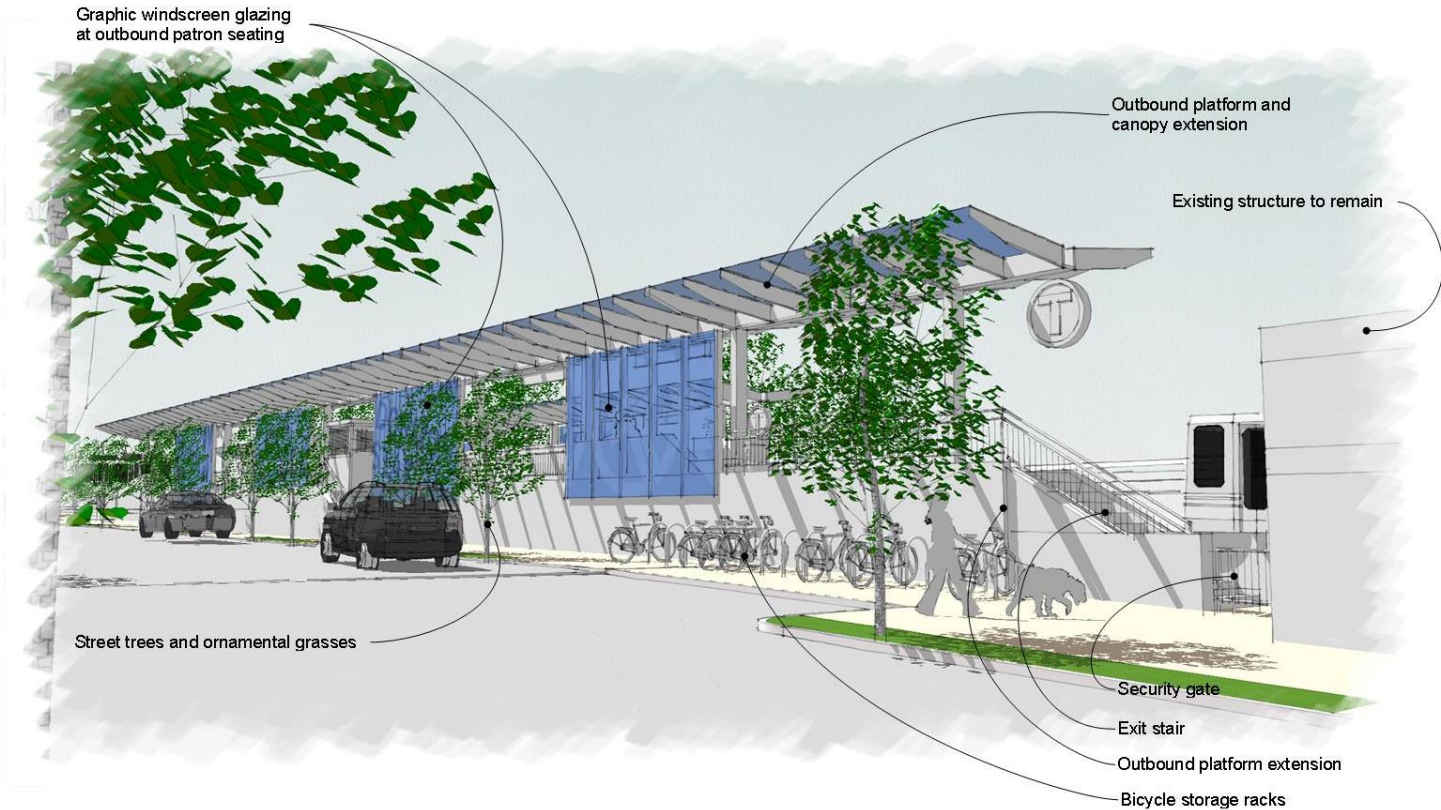

# Visit the project website for more information!

[PortAuthority.org/DormontJunction](https://PortAuthority.org/DormontJunction)



Port Authority is gathering input from the community on the redesign of Dormont Junction Station as part of our **Station Improvement Program**. Through this project, we are looking to enhance customer amenities at the station, increase ridership, and encourage new development in the area.

Please check back with this page to learn about the latest information and opportunities to provide feedback.

## Register for an Online Public Meeting

Please join us for an online public meeting to review 30% design of the Dormont Junction Station Improvement Project:

**Monday, April 26, 2021 from 6-7:30PM**

[Click Here to Register](#)

## Projects and Programs

[Station Square Station Improvement Project](#)

[Dormont Junction Station Improvement Project](#)

[Mt. Lebanon Tunnel Ventilation Project](#)

[Belasco Station Project](#)

[Bus Shelter Program](#)



# Questions + Comments

